



# Content

- 01 Wi-Fi Alarm System / Content
- 02 Features
- 03 LED Indication / Button Operation
- 05 Door & Window sensor
- 06 Wireless P.I.R Motion Detector

## Apps Setup

- 10 Mobile App Download / Create an Account
- 11 Add Device
- 13 Alarm System Interface
- 14 Quick Alarm Operation

## Accessories Management

- 15 Add Accessories
- 16 Delete Accessories
- 17 Zone Setup
- 18 Device Setup
- 20 Other Apps Setting
- 24 Specifications
- 26 Frequently Asked Questions

# Wi-Fi Alarm System

This Wi-Fi alarm system is totally through Wi-Fi transmission with fast speed and no need any extra fee. It can expand to 40pcs wireless accessories and 10pcs remote controls. The intuitive different color LEDs light up for status of arming, disarming, alarming. The all-in-one mobile App"Smart Life"allows users to remotely control the system anytime, anywhere. And this system is compatibal with Tuya Smart, Amazon Alexa and Google Assistant.

## Content

Open the package, and contact the supplier if there's anything missing.

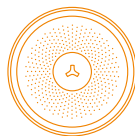

Control Panel



Door/Window  
Sensor



Remote  
Control



P.I.R. Motion  
Detector



Power  
Adapter



Plastic Plugs  
& Screws



User  
Manual

## ★ Features



Wireless  
DIY Installation



3 Colors  
LED Indicator



Entry/  
Exit Delay



Strong  
Range Up to 80m



90dB Siren



Quick Arming &  
Disarming



40 Customizable  
Sensors



10 Remote Control  
Names



8 Hours Battery  
Back-up



FHSS  
Frequency-hopping  
Spread Spectrum

## LED Indication

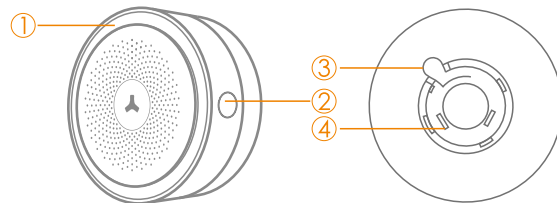

No	Name	Function
1	LED Backlight	<p>Flashes once in red: ready for configuration with new accessories.</p> <p>Keeps On in green: System disarmed.</p> <p>Keeps On in blue: System armed.</p> <p>Keeps flashing in blue: System armed in Home Mode.</p> <p>Flashes quickly: Wi-Fi connection lost.</p>
2	Function Button	<p>Press once: start the enrollment with new accessories.</p> <p>Press and hold for 5 seconds until one beep heard (or press 3 times): start the setup with the App.</p> <p>Press 10 times: turn off the system.</p> <p>Press 5 times: reset the system to factory settings.</p> <p>Press and hold for 7 seconds until one beep heard: delete all the enrolled accessories</p>
3	Plug Handle	Press the handle, to fix the plug. (See picture)
4	Interchangeable Plugs	Change the plugs suitable for your country.

## Installation

1. Fix the plug on the base properly by rotating
2. Power on the Siren

Power the siren by directly plugging it into the electrical outlet, the siren beep once and the LED indicator light up in green?

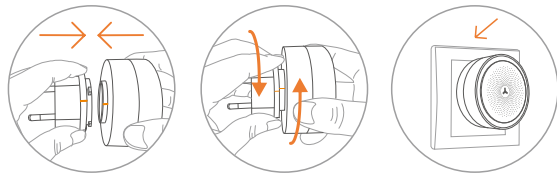

### Note:

1. The back-up battery is only for emergency use, AC power should be the main supply.
2. Do not hit or drop the device in case of damage component inside.
3. The system should be tested regularly, so that all fault can be fixed in time.



## Door & Window sensor

The Door/Window Sensor can be installed on doors, windows and any other objects that open and close.

The tamper protection ensures that sabotage attempts to move the sensor will result in an alarm activation.

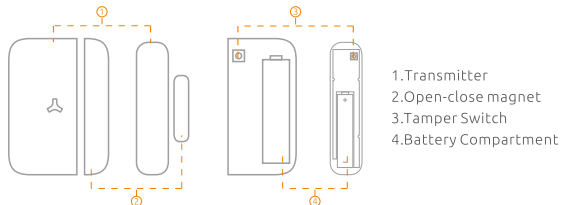

**Note:** The sensor flashes once per 3 seconds when it's in low battery.

- Open the case and install the battery properly.
- Remove the strip from the reverse of the double sided tape and carefully mount the transmitter and the magnet.
- Make sure your chosen position is clean, free from dust or moisture and away from areas with a large quantity of metal or electric wiring.
- It will cause an immediate alarm if the magnet is departed from the transmitter more than 2cm in arming status.

Vertical Installation

Horizontal Installation

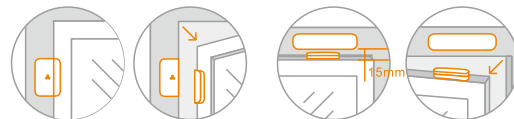



## Wireless P.I.R Motion Detector

### Features

The passive infrared sensor with novel and beautiful style, perfect streamline can be easily installed. It is designed to detect human movement indoor. Adopted advanced fuzzy logic chip and intelligent analysis distinguish signal between body movement and interference to minimize false alarms. The built-in buzzer remind you low battery state and event of tamper alarm, which ensure your safety.

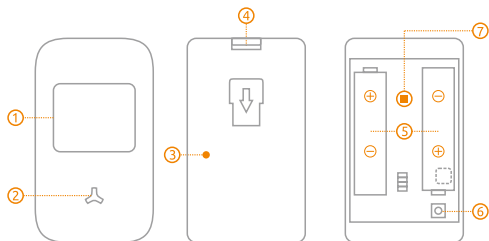

1. Detection Window
2. LED Indicator
3. Learning Button
4. Clip
5. Battery Compartment
6. Tamper Switch
7. Infrared Sensor

**Infrared Sensor:** Detects the infrared rays released by human body motion.

Please do not touch the surface and keep it clean.

**Tamper Switch:** Once the case is opened , the tamper switch will be triggered, generating an alarm signal.

### Status Indicator



**LED Flashed Once:**

Movement is detected, Tamper alarm.

**LED Flashes Once each 3 seconds:**

Low battery indication.

If it's in low battery state, please replace it immediately.

### Installation & Walk Test

With the Detector powered on, the light should turn on immediately and will keep flashing while the sensor warms up, for approximately 15 seconds. It will then turn off.

**Test Mode:** After warm-up, walk through the coverage area and the light should turn on. This confirms that the movement is detected. The detector will recognize the movement 5 times. The interval time between each detection should be more than 2 seconds. Then it enters in sleeping mode.

**Sleeping Mode:** In this mode, the sensor detects motion constantly, but will only trigger the alarm on the first two detections. After 3 minutes, the sensor will reset ready to trigger the alarm. The mode helps save considerable amounts of energy when the house or apartment is inhabited and people are constantly moving around.

#### Walk Test:

After the sensor warm up, walk across detection area and watch the LED indicator to make sure it flashes once when detecting the movement.



#### Notice

1. Avoid mounting the detector close to places where heat changes fast or air stream flows frequently. (ie. Air conditioner, tube light, oven, waver, refrigerator etc.)
2. Avoid it facing to window which can be easily interfered by complicated environment. (ie. sunlight, crowds, or flowing cars etc.)
3. The product can reduce the possibility of accident, but the user is advised to take all necessary precautions for the safety and the protection of the property.



#### Detection Area

Top View

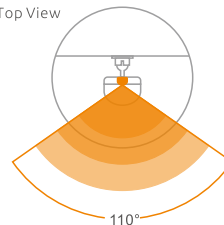

Side View

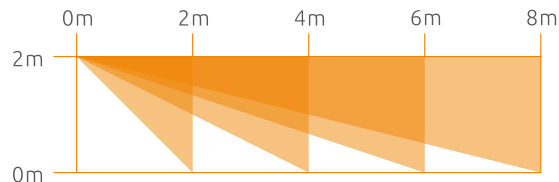
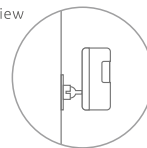



## App Setup

### Mobile App Download

Please enter keyword **"Smart Life"** on your smart phone to download the App from the Apps store or Google Play.



Smart Life

Wi-Fi Network: 2.4GHz (802.11 b/g/n).

iOS Requirements: iPhone 4S or newer running iOS 8 or higher.

ANDROID Requirements: Android 4.0 or newer.

### Create an Account

Tap on **"Register"** and follow these steps to create an account for your devices.

## Add Device

1. Tap on **"Add Device"** or **"+"**. Tap on **"Sensor"** and choose **"Alarm (Wi-Fi)"**

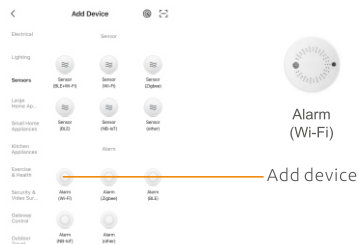

2. Select 2.4G Wi-Fi network and enter your Wi-Fi password.

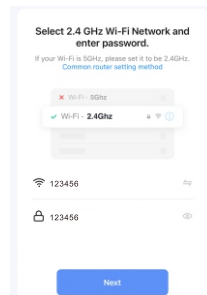

3. Turn on the device and confirm that “backlight” of the device flash in red quickly and then choose blink quickly on the app.

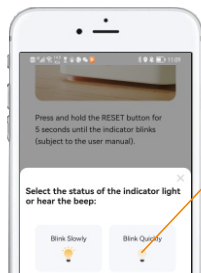

How to make backlight flash in red quickly?  
\* Turn on the device, then press the enroll/reset button for 5 seconds

4. Waiting for seconds while connecting.



Adding device...  
Keep the network stable.



01:55

5. Device added successfully. Then you can rename the device and choose where you place the device.

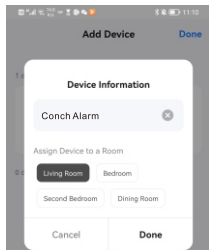

## Alarm System Interface

Once the alarm system has been connected to your app, the dashboard will be displayed.

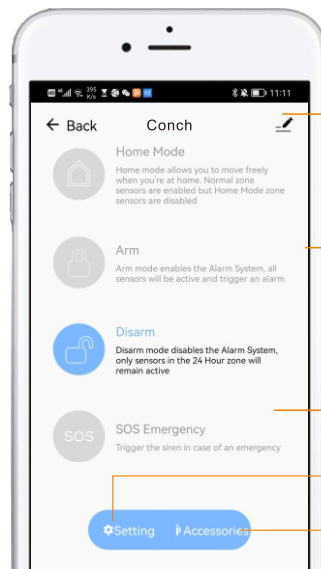

Basic information about the device

Security Mode  
The Alarm System has three security modes

Emergency SOS Alarm  
User can choose to sound the siren

System Setting

Management Accessories  
Add/ Delete/ Edit accessories





## Quick Alarm Operation

You can arm, disarm and switch between security modes using mobile app and remote control.

1. Operation through the APP

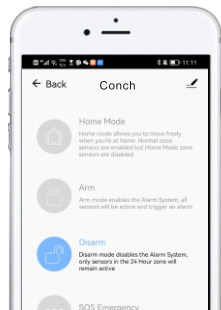

2. Operate through the Remote Control (Press and hold the buttons for about 1 sec.)



Arm

Mode for no one at home. It sends notifications when any detector is triggered.



Stay Arm (Home Mode)

This mode is for someone at home. Normal zone sensors are enabled while home mode zone sensors will be disabled.



Mute Mode

Press **home mode** button, then press **arm** or **disarm** button within 3 seconds to enter into arming or disarming state in mute mode without disturbing someone.



Disarm

The alarm system is disabled. Only sensors in 24 hour zone will trigger the alarm.



Emergency Call

User can choose to sound the siren or call the emergency number.





## Accessories Management

Tap on "  Accessories " icon enters into accessories menu, users can enable/disable, add/delete different accessories. It's highly recommended to set the zone name to recognize the location when it's alarming.

### Add Accessories

Accessories in the standard kit were enrolled by default. More accessories can be paired in two ways.

Press the enroll button .

**Step1**, Press the enroll button on the side of the panel or select the "  Accessories " on the dashboard to enter the Accessories Menu, then tap on "  Add " icon.

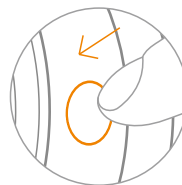

By enrolling button

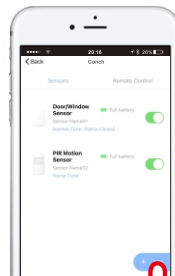

+ Add

Step 2, Trigger the sensors one by one. How to trigger different accessories:

#### Sensors



Press the black button on the rear of the motion sensor.

#### Remote Control

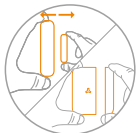

Move the transmitter away from the magnet



Press any button on the remote control.

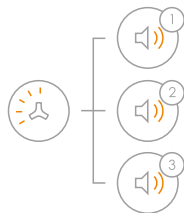

1 System beeps once, the LED light flashes once, the enrollment is successful.

2 If system beeps twice and the LED light flashes once, the accessories have been enrolled before.

3 If three beeps are heard and LED light flashes once, the storage is full.

(Note! Please don't press tamper switch to enroll or enroll accessory in low battery status.)

## Delete Enrolled Wireless Accessories

Delete accessories via APP or press the enroll button 7 times until one beep is heard, all enrolled wireless accessories will be deleted.

## Zone Setup

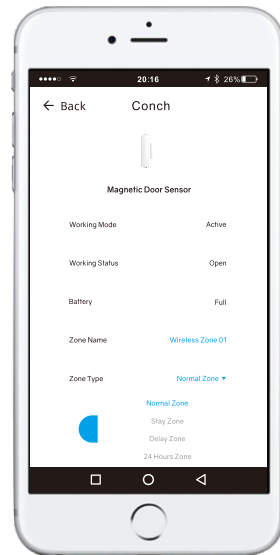

### Normal Zone

The alarm is activated immediately when triggered.



### Delay Zone

It allows a delay before entry or exit especially for sensors in single delay zone. But accessories in normal zone, home mode zone, and 24H zone will not be delayed.



### Stay Zone

Press " " button, sensors in home mode zone are disabled then the users can move freely. While the sensors in normal zone will still activate an immediate alarm when triggered.



### 24 Hour Zone

No matter what state the alarm system is in, the accessories in 24 Hour zone are triggered, the control panel will get the signal and alarm immediately.

:Full power, :Low Battery



## Device Setup

Tap on "  Setting ", enter the setting interface.



### Alarm Duration Time

User can set the siren duration from 0s to 300s, the device will be in mute when user set it 0s.



### Schedule

Schedule the arming and disarming of your security systems at your convenience. Time tolerance may be about +/- 30 seconds.



### Backlight LED

User can turn the LED on or off.



### Change Language

Select the device language as you want.



### Exit/ Entry Delay

Set exit/entry delay time for accessories in single delay zone. It allows users to leave or enter home within the programmed time without activating an instant alarm. Once entry/exit delay time is set, when system is armed, in case of delay time less than 10 seconds, control panel will beep twice every second. When the delay time is more than 10 seconds, control panel will beep once every 2 seconds, the sound will increase in tempo for the last 10 seconds for the "hurry up" notification. Once an entry is detected, it will allow the user to enter and disarm the system within the programmed entry time



### Keyfob Arming/Disarming Alert

Get notified who is operating the system via keyfob.



### Door Sensor Monitoring

If you leave a door or window open when you arm the system, the alarm will send a alert notification. User can check the real-time status of which sensor is "open" on the sensors list.



## Other APP Settings



### My home

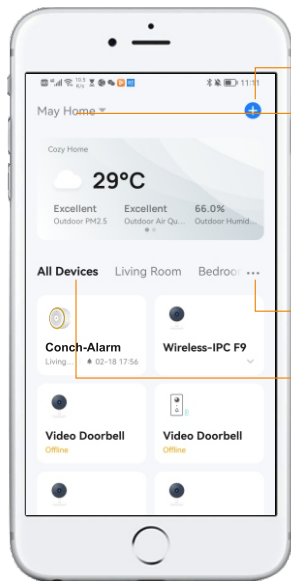

● Add devices

● Home Management

Family settings: Name change/  
Room management/Family  
location/ Share advices  
Add Family/Add rooms.

● Room Management  
Add/Delete/Edit rooms

● Set Home Location



## Smart

Tap on "Smart" to add smart scene or automation of your connected devices.

For example, arm the system, and turn off the smart bulb.

Or disarm the system, and then turn on the smart bulb.

Or to excute the actions according to different condicions. For example, when temperature greater than 40℃, trigger the alarm system.

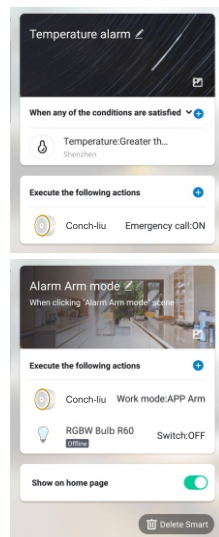
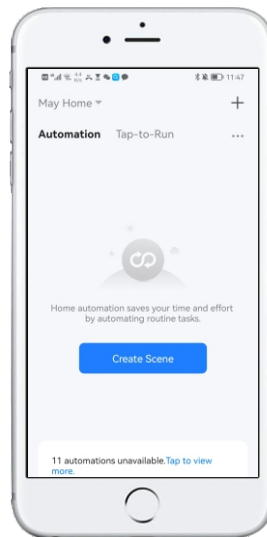



1. Add other services, like Alexa...



Alexa



GoogleAssistant

2. Check the activities of the system



Conch: System Disarmed.

2018-10-27 16:10:08



Conch: System Armed in Away Mode!

2018-10-27 16:09:54

3. Write down and send us your issues or complaints or any feedback.

4. Sound: Turn on/off the sound of the key on APP.  
Notificaion: Receive the push notification or not.

Sound



Push Notification

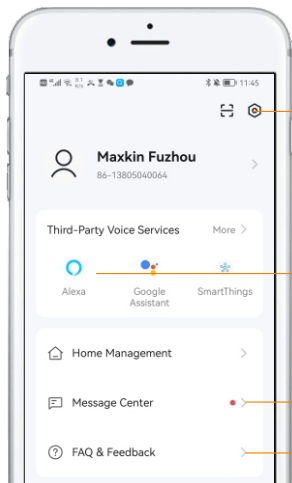

## Specifications

Product Name :	Two-way Portable DIY Wi-Fi Alarm System
Control Panel's Power Supply :	Input: AC 110~240V/50~60Hz
Built in Battery:	600mh/3.7V
Internal siren :	90dB
Allowed Amount of Expandable Wireless Accessories	10pcs remote controls 40pcs wireless accessories
Operating Frequency	2.400~2.4835GHz
Wi-Fi Standards	802.11b/g/n
Radio Frequency	433.2MHz, 433.9MHz, 434.4MHz
Housing Material	ABS plastic
Operating Condition:	Temperature: -10°C~55°C Humidity: ≤ 80%(non-condensing)
Size (Dx H) :	Φ80×41.7mm



## Specifications

Power Supply:	DC1.5V (AA Battery )
Standby Current:	≤25 μA
Transmit Current:	≤70mA
Wireless Transmit Distance:	≤80m (in open area)
Wireless RF Frequency:	433.2MHz, 433.9MHz, 434.4MHz
Temperature/Humidity:	-10°C~55°C/≤80% (Non-condensing)
Detector Dimensions(L x W x H):	24.5 x 96.5 x 19.5 mm
Magnet Dimensions (L x W x H):	14 x 48 x 11 mm



## Specifications

Power Supply:	DC1.5V (AA 1.5V Lr6 Battery x1)(EXCELL, GP)
Standby Current:	≤20 μA
Transmit Current:	≤70mA
Wireless Transmit Distance:	≤80m (in open area)
Wireless RF Frequency:	433.2MHz, 433.9MHz, 434.4MHz
Temperature/Humidity:	-10°C-55°C/≤80% (Non-condensing)
Dimensions (L x W x H):	48 x 71 x 18mm



## Specifications:

Power Supply:	DC 3V (AA 1.5V LR6 Battery x 2pcs)(EXCELL, GP)
Standby Current:	≤20μA
Transmit Current:	≤30mA
Detection Area:	7-8m/110°
Wireless Transmit Distance:	≤80m (in open area)
Wireless RF Frequency:	FHSS 433MHz
Temperature/Humidity:	-10°C-55°C/≤80% (non-condensing)
Detector Dimensions (LxWxH):	90x 52x 36.5mm
Bracket Dimensions (LxWxH):	48x 26x 29mm



## Specifications:

Power Supply:	DC 6V(2pc CR2032 button cell battery)
Transmit Current:	≤25mA
Wireless Transmit Distance:	≤80m (in open area)
Transmitting Frequency:	433.2MHz, 433.9MHz, 434.4MHz
Housing Material:	ABS plastic
Operating Condition:	Temperature: -10°C~55°C Humidity: ≤ 80%(non-condensing)
Dimension (L/W/H):	37x70x11.5mm



## Frequently Asked Questions

---

### 1. Is it possible to expand more accessories for this alarm system?

Yes, 40pcs sensors and 10 remote controls can be expanded according to users' need. Full range of accessories will be offered including PIR motion sensors, door sensors, vibration sensors, flood sensors, keypads, sirens and premiere protection beams & fences, environmental sensors like smoke detectors, please refer to details of Accessories.

### 2. What happens in case of alarm?

The system will alarm immediately, and Wi-Fi alarm sends you the push notification directly to your mobile Apps.

### 3. What internet connection do I need for Wi-Fi system?

All contemporary Wi-Fi standards on 2.4 GHz are supported. Network speed can influence the system performance.

It is recommended to use a fast and well-functioning Internet connection for optimum performance.

### 4. Do I have to pay for a app?

All available Smart Life Apps are free to download (App Store or Google Play). The complete functionality is free.

### 5. How to download the app for Wi-Fi alarm system?

Go to App Store or Google Play to download the application by entering the key word of "Smart Life".

### 6. Is Smart Lift App suitable for all mobile phones?

On all smartphones with a recent version of an iOS or Android operating system, Apps are available for download and use. For this functionality, depending on the system, a mobile connection or mobile Internet / Wi-Fi connection is necessary.

### 7. What's the maximum range between the control panel and accessories?

It's 80 meters in open area. The walls might shorten the distance, it's recommended to install the accessories at the right place, and move the panel to adjust a better signal receiving. If the house is too large, it's better to add a signal repeater to boost the coverage.

### 8. Will my alarm system work in the event of a power failure?

Yes, They system has rechargeable back-up batteries which can support it working for 8 hours. When the power is recovered, the battery will be recharged.

## PIR Motion Detector

### 1. Why PIR Motion detector does not detect movement?

- A. Please make sure the control panel is in arming status, not at stay (home) mode or disarming status.
- B. Please make sure the LED of PIR motion detector lights up when you walk in the detection area.
- C. Movement should cross the detection and within 8 meters range.

- D. The detector enters sleeping mode to save power after 5 detection.  
If there's no movement within 3 minutes, the detector will reset ready to trigger the alarm.
- E. Make sure the insider battery contact well or not.
- F. Check the board put well or not.

## 2. If the PIR motion detector pet-immunity?

No. The PIR supplied in standard kit is normal PIR. If you have pets at home, please adjust the installing height to allow your pets to roam below the mounting height of the unit without causing alarms.

## 3. There's no one passerby the room, but the detector trigger the alarm

- A. Check if there's any pet at home, the PIR supplied in the standard kit is normal one, not pet-immune one.
- B. Please avoid mounting the P.I.R. motion detector at the place where rapid heat changes such as window, air conditioner, light, electric heater, refrigerator, oven, stove etc.
- C. Avoid strong sunlight.
- D. The installation height and range should be in the detection area.